

Spot Leak Detectors



Spot Leak Detectors

DESCRIPTION

SD, SD-R01, SD-Z and MX1 Spot Detectors detect conductive fluids at a single point for the most economical way to detect fluids in small, confined areas. These devices are commonly used in small rooms and in air-conditioning drip pans. Use only with SC conductive fluid leak detection cables.

Veris offers four models of spot detectors which can integrate with various building management systems.

| MODEL | DESCRIPTION |
|--|--|
| SD Spot Detector | <ul style="list-style-type: none"> Operates on either 12-36VAC or 18-36VDC power Includes a 14 ft (4.2 m) leader cable |
| SD-R01 Spot Detector with Relay Output | <ul style="list-style-type: none"> Works with any system that accepts dry contacts Operates on 24VAC/VDC±10% Automatically resets when conductive fluid is no longer present (AC power only; if DC power is used, device must be reset by disconnecting power momentarily) Includes a 14 ft (4.2 m) leader cable |
| SD-Z Spot Detector | <ul style="list-style-type: none"> Designed for use with the all detection panels, with SC sensing cable to integrate both zone and spot detection into one panel Powered by the LD300, LD1000, LD5100, LDRA6, or LD2000 When used with a distance read panel (LD2000 or OD5100), the location of the leak will be identified (simulates 50 feet) Includes one male and one female end connector, each on a 1 ft (30 cm) lead wire |
| MX1 Spot Detector | <ul style="list-style-type: none"> Battery-operated or 12-30VDC/24VAC powered |

FEATURES

- Simple installation – screw, or ram-set to floor (SD, SD-R01, SD-Z)
- Simple operation – no maintenance
- Solid-state design...no moving parts to fail
- SD, SD-R01, SD-Z models have polymer-coated sensing probes...no exposed metal that will rust
- All models are fully potted for water-proofing...maximum durability

SPECIFICATIONS (SD, SD-R01, SD-Z)



Input Power (SD-R01 Only)

24VAC/VDC ± 10%; 0.1A max.

Outputs:

Solid-state (SD Only)

12-36VAC@0.01A min., 0.1A max.; 18-36VDC@0.01A min., 0.1A max.

Relay (SD-R01 Only)

Dry Contact, Form C; 1 A@24VDC, 0.5A resistive@120VAC

Leader Cable (NSC):

Length

SD: 14 ft. (4.2 m); SD-R01: 14 ft. (4.2 m); SD-Z: 10 ft. (0.3 m) (2 cables included)

Connector (SD-Z Only):

1 male, 1 female; 4 pin, 0.96" (24.38 mm) diameter; connects to SC or NSC Cable

Operating Environment:

Temperature

0° to 50°C (32° to 122°F)

Humidity

5% to 95% RH non-condensing

Altitude

10,000 ft. (3,048 m) max.

Storage Environment

-20° to 70°C (-4° to 158°F)

SPECIFICATIONS (MX1)

Input Power

12-30VDC/24VAC; 10-year lithium battery model available

Max Current Draw, Voltage Units Only

10mA

Output

N.C. solid-state, (opens on alarm)

Output Rating

30VAC/DC@0.1A max., not polarity sensitive

Sensing Electrodes

Gold plated

Operating Environment:

Temperature

-20° to 80°C (-4° to 176°F)

Humidity

0 to 100% RH

APPLICATION/WIRING DIAGRAMS

DIMENSIONAL DRAWINGS

SD

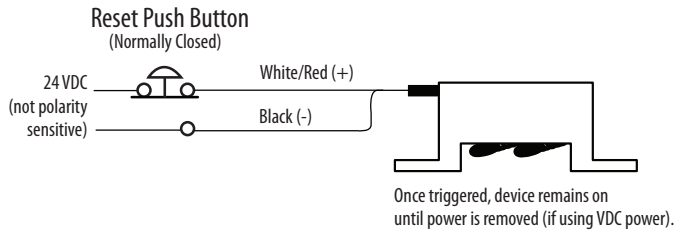

SD-R01

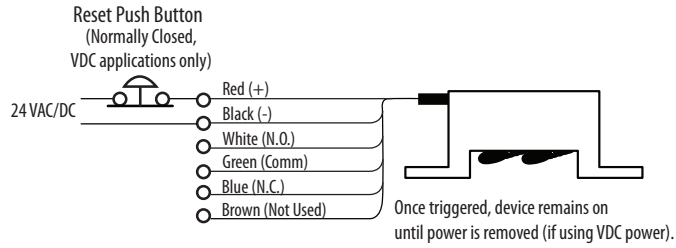

SD-Z

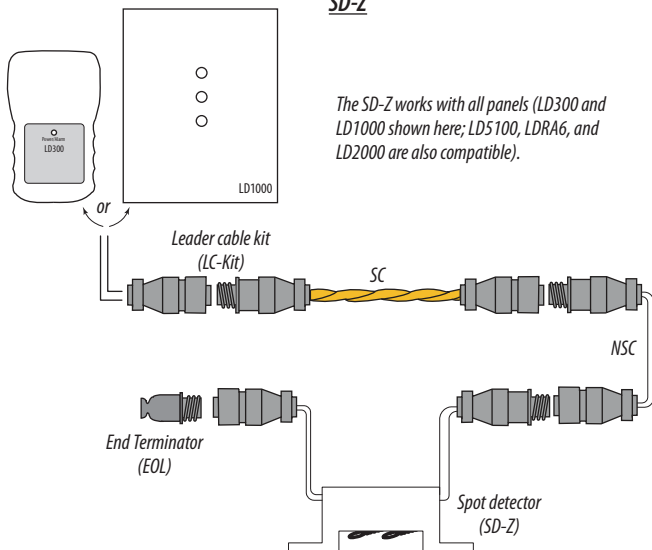

MX1 Series

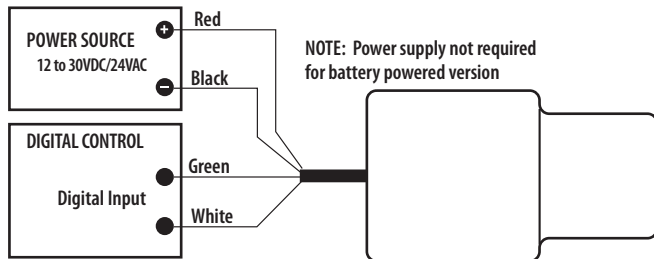

SD thru SD-Z

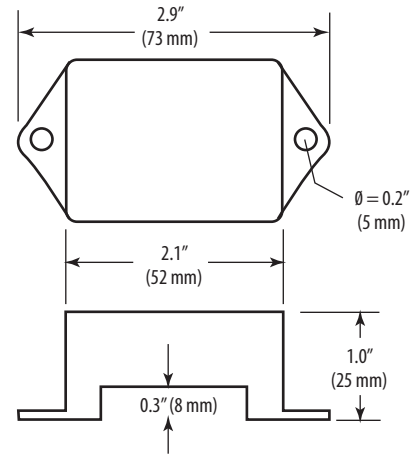

MX1 Series

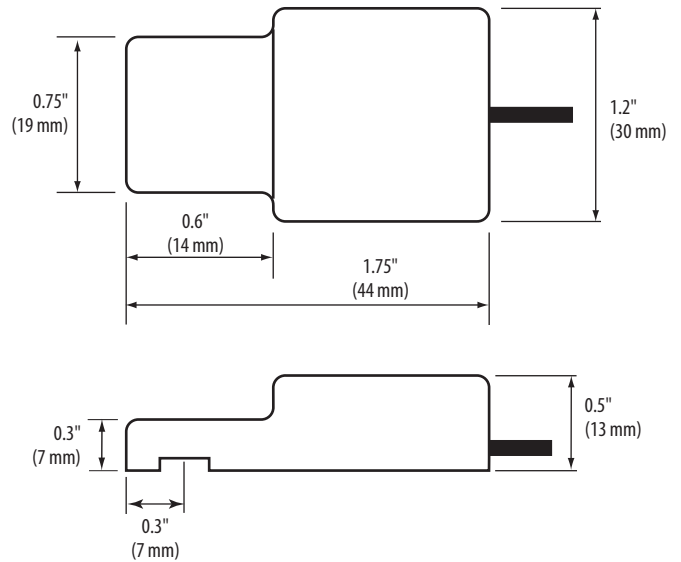

ORDERING INFORMATION

| MODEL | MANUF. PART # | DESCRIPTION | CE | RoHS | ETL |
|-----------|---------------|--|----|------|-----|
| U006-0006 | SD* | Spot Detector, 14' leader cable | ● | ● | ● |
| U006-0007 | SD-R01* | Spot Detector, 14' leader cable, relay out | ● | ● | ● |
| U006-0008 | SD-Z* | Spot Detector, 2x10" leader cable | ● | ● | ● |
| MX1B | MX1B | Spot Detector, battery | | | |
| MX1V | MX1V | Spot Detector, 12-30VDC/24VAC | | | |

* These devices work only with the SC conductive fluid detection cables.